



# CP Lead Safe™ Fixed Basin Outlet Aer Comp Gooseneck (5/8 MI)

PRODUCT CODES:

- 174.90.40.00



## SPECIFICATIONS

- Fixed design.
- Robust construction for long life.
- Low maintenance.
- Finished in bright chrome plate for easy cleaning and durability.

**IMPORTANT:** All spouts are tested in accordance with AS/NZS 3718 and leave our premises in good working order.

\*Our Lead Safe™ product range is compliant with the Lead Free Requirements of the NCC 2022 Vol. Three, Clause A5G4(2) and NSF/ANSI 372.  
\*\*Any flow controller incorporated in the outlet to be tightened to prevent removal by hand. As Per AS3718.

**WARNINGS:** Special attention to be paid on notes, photos, images, or drawings of assembly steps marked with the warning symbol.



## TECHNICAL DATA

|                                |               |     |
|--------------------------------|---------------|-----|
| Inlet                          | G 5/8" - Male |     |
| Outlet                         | Aerator       |     |
| Working Pressure Range (kPa)   | Min           | 50  |
|                                | Max           | 500 |
| Working Temperature Range (°C) | Min           | 5   |
|                                | Max           | 65  |
| Nominal Flow Rate (LPM)        | 5.43          |     |
| Construction                   | Brass         |     |
| Finish                         | Chrome        |     |

**NOTE:** Galvin Engineering continually strives to improve their products. Specifications may change without notice.

## TOOLS REQUIRED

- Power drill
- Spanner or adjustable crescent
- Thread tape

**PRE-INSTALLATION**

**MOUNTING DETAILS**

- If the mounting holes do not already exist, mark out and drill the holes in the bench/trough, as shown in rough-in dimensions.

**⚠ Note:** Before installation, all lines must be flushed. We recommend that a line strainer be installed prior to eliminate any foreign material.

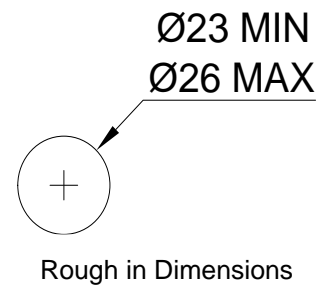
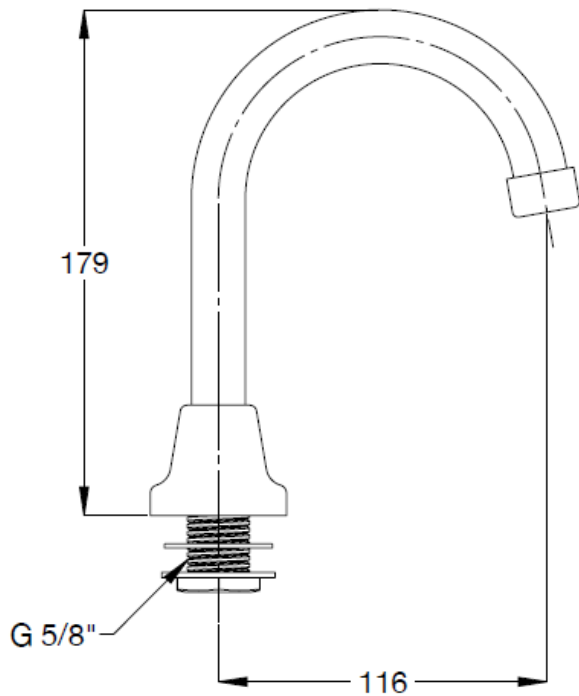

**INSTALLATION**

**IMPORTANT:** Galvin Engineering products must be installed in accordance with these installation instructions and in accordance with AS/NZS 3500, the PCA and your local regulatory requirements. Water and/or electrical supply conditions must also comply to the applicable national and/or state standards. Failing to comply with these provisions shall void the product warranty and may affect the performance of the product.

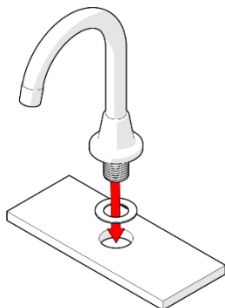

**1. Fit spout**

- Fit the spout into the bench.

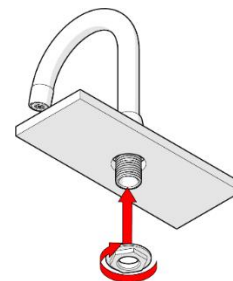

**2. Secure the spout**

- Secure the spout underneath with the supplied washer and back nut.

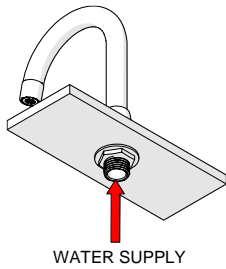

**3. Connect**

- Connect the outlet to the water supply.
- When applying thread tape or sealant to the inlet, ensure the opening is not obscured.

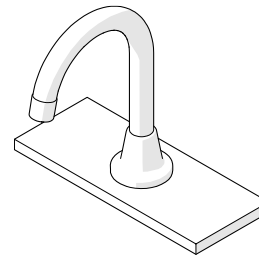

**4. Testing**

- Turn on the water supply and test for leaks.

| TROUBLESHOOTING                   |                                                        |                                                               |
|-----------------------------------|--------------------------------------------------------|---------------------------------------------------------------|
| PROBLEM                           | CAUSE                                                  | RECTIFICATION                                                 |
| Inconsistent flow                 | Blocked aerator<br>Blocked top assembly                | Remove aerator and clean<br>Remove top assembly and clean     |
| Water is not flowing from the tap | Water is turned off                                    | Turn on the water                                             |
| Continuous flow                   | Top assembly loose or internally obstructed or damaged | Remove top assembly, clean with water and replace if required |

**WARRANTY**

Galvin Engineering products are covered under our Manufacturer's Warranty. Galvin Engineering products must be installed in accordance with the installation instructions and in accordance with AS 3500 and NCC Volume Three, relevant Australian Standards and local authorities applicable to product being installed. Water and electrical supply conditions must also comply to the applicable national and/or state standards, failing to comply with these provisions may void the product warranty and affect performance of the product.

Please visit [www.galvinengineering.com.au](http://www.galvinengineering.com.au) to view the full warranty, our Installation Compliance and Maintenance & Cleaning information as well as any other additional information.